

North Boulder Warehouse Space for Lease

4571 N. BROADWAY | BOULDER, CO
UNITS 3 & 4

Unit 3: 1,486 SF

Unit 4: 3,220 SF

Combined: 4,706 SF

Lease Price: \$18.00/SF NNN (\$8.00)

Available: Now

WHEN ONE DOOR CLOSES

Another one opens, and sometimes A LOT of them open. That's the case with this North Broadway warehouse space which has all the opportunity you'd expect including new overhead doors. Take your pick from one or both of the available units (1,486 SF | 3,220 SF | 4,706 SF) and gain access to all the other impressive doors that lead to views of the foothills, loads of parking...and even two brand new restrooms. Dream big, there's space for it. Don't be a knob! Come get your foot in the door!

PROPERTY HIGHLIGHTS

- New overhead doors and restrooms
- Easy access and parking
- Flexible unit sizes
- Walking distance to restaurants and coffee, with a Boulder zip code



[CLICK HERE](#)
for virtual tour



LEARN MORE ABOUT THIS PROPERTY
MarketBoulder.com

DISCLAIMER: The information contained herein has been obtained from sources believed reliable. While we do not doubt its accuracy, we have not verified it and make no guarantee, warranty or representation about it. It is your responsibility to independently confirm its accuracy and completeness.

CLICK HERE
for virtual tour

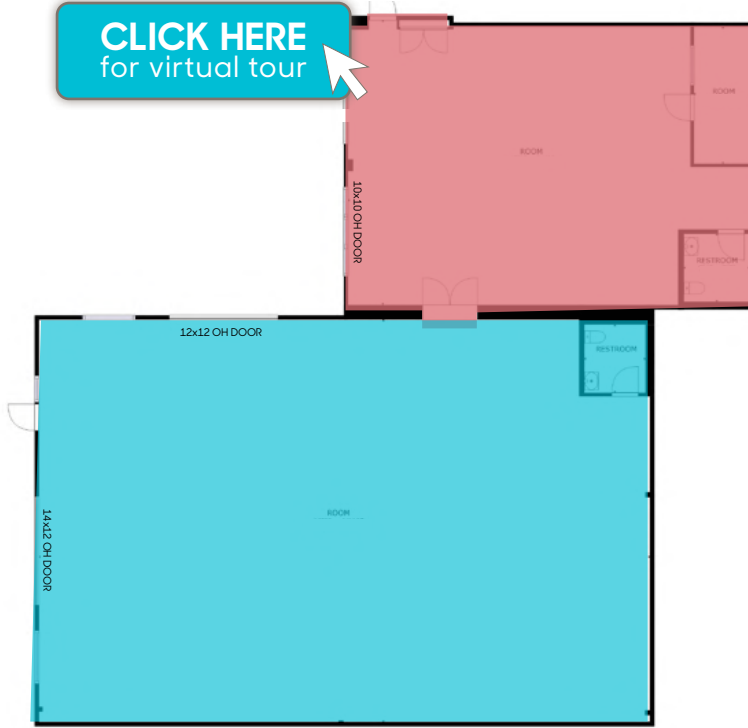

- UNIT #4**
1,486 SF
- UNIT #3**
3,220 SF

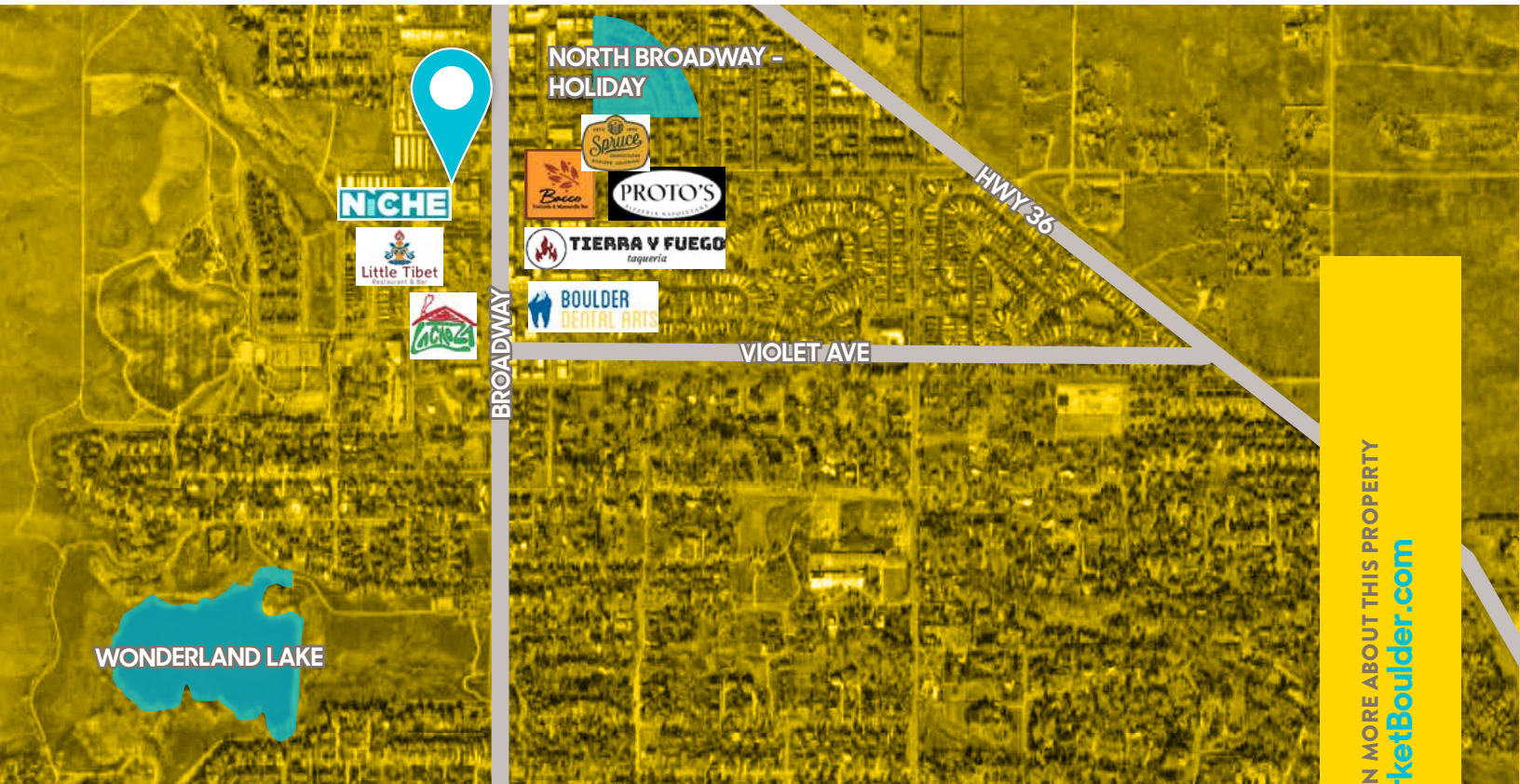

LEARN MORE ABOUT THIS PROPERTY
MarketBoulder.com

TODD WALSH
303 444 5040 Todd@MarketBoulder.com

HEIDI SCHAMBER
303 444 4344 Heidi@MarketBoulder.com

