

## Longmont Industrial Space for Lease

23 BOSTON COURT | LONGMONT, CO 80501

### UNIT D

Size: 1,200 - 1,600 SF

Rate: \$2,100 - \$2,800 MG

**OUTDOOR STORAGE AVAILABLE**

# NO-NONSENSE WAREHOUSE

Say goodbye to waiting and hello to your new warehouse space! This MU-E zoned industrial space is ready for your business or storage needs without delay. Equipped with a 10' overhead door, hanging heater, and private restroom for convenience, this space has everything you need to hit the ground running. Located in a prime central Longmont area, you'll be right where the action is. Secured yard storage potential.

### PROPERTY HIGHLIGHTS

- Straightforward, functional warehouse space
- Central Longmont location
- Unit has an overhead door, hanging heater & private restroom
- Power: 120/240v single phase
- Door Height: 10' OH Door
- Fenced Yard Available



OUTDOOR YARD STORAGE



[CLICK HERE](#)  
for A-D virtual tour



FRONT



LEARN MORE ABOUT THIS PROPERTY

[MarketRealEstate.com](https://MarketRealEstate.com)



# market

REAL ESTATE

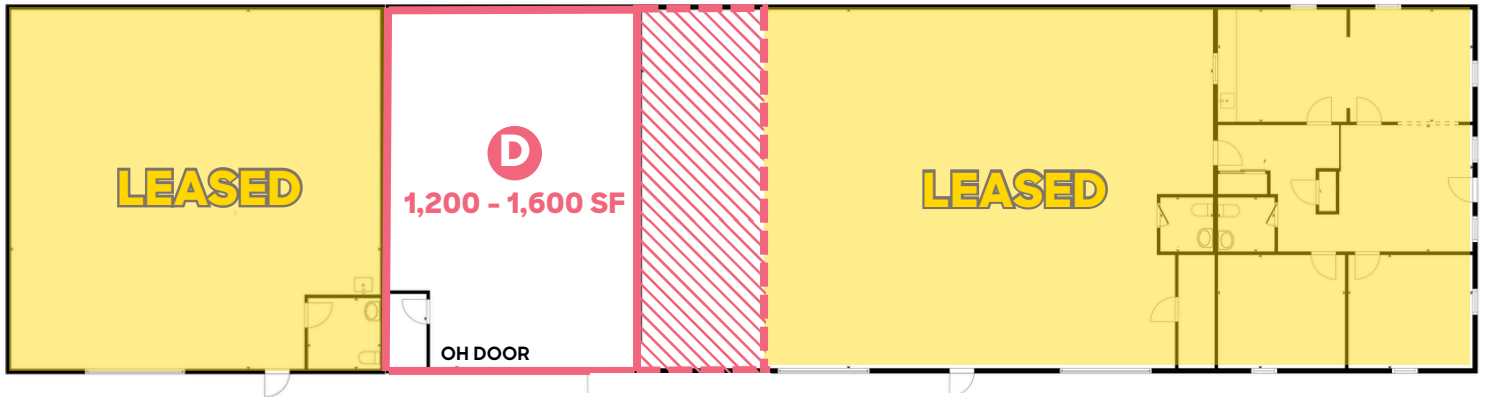

[CLICK HERE](#)  
for A-D virtual tour



LEARN MORE ABOUT THIS PROPERTY  
[MarketRealEstate.com](http://MarketRealEstate.com)

**HEIDI SCHAMBER**

303 444 4344  
Heidi@MarketRealEstate.com

**ANNIE LARNER**

303 444 1344  
Annie@MarketRealEstate.com

